

## ADAM BATHROOM/CLOAKROOM HANDLE WITH PRIVACY TURN

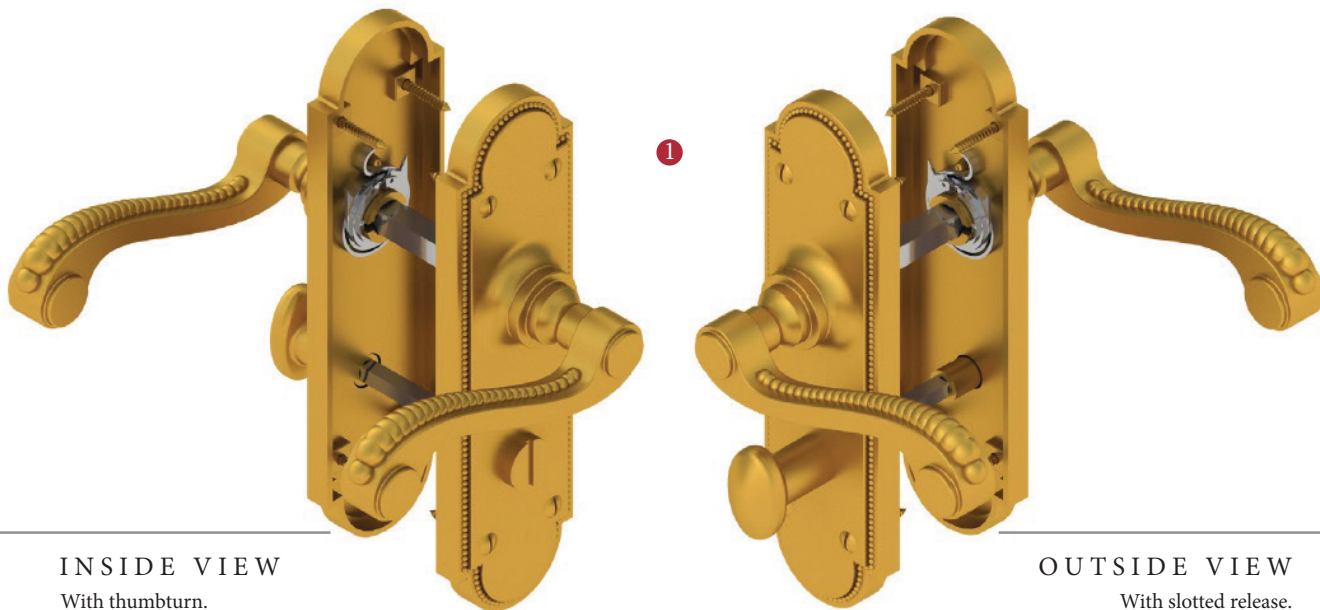

**INSIDE VIEW**

With thumbturn.

**OUTSIDE VIEW**

With slotted release.  
Used to open door in emergency.

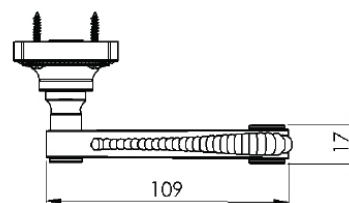
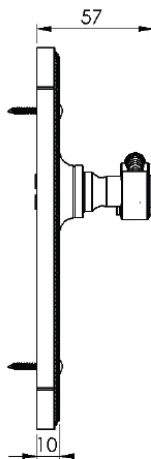
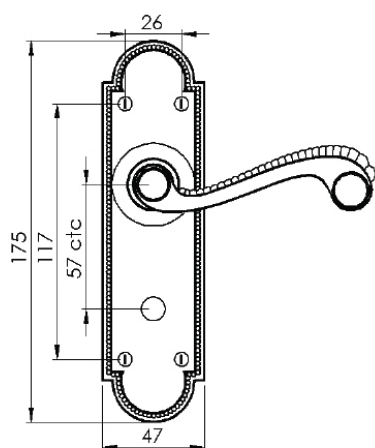

This bathroom handle is suitable for use with most U.K. bathroom locks with a 57mm CTC.  
For a new door installation we would recommend using our York bathroom locks from the list below.



Thumbturn x 1pc.



Spindle : 7.8mm x 85mm - 1pc.



2 mm Allen key :  
Used to fasten thumbturn



8x Brass wood Screws  
Fasten the Brass Screws into the Pilot holes



Iron starter screw x 1pc.  
Drill pilot holes, use the starter screw to cut a thread

### BATHROOM LOCKS

(not Included, must be ordered seperately)

YKBL2-AT	2 1/2" Antique Finish
YKBL2-BLK	2 1/2" Black Finish
YKBL2-MB	2 1/2" Matt Bronze Finish
YKBL2-PB	2 1/2" Brass Finish
YKBL2-PC&PN	2 1/2" Polished Chrome & Nickel Finish
YKBL2-SB	2 1/2" Satin Brass Finish
YKBL2-SN&SC	2 1/2" Satin Nickel & Chrome Finish
YKBL3-AT	3" Antique Finish
YKBL3-BLK	3" Black Finish
YKBL3-MB	3" Matt Bronze Finish
YKBL3-PB	3" Brass Finish
YKBL3-PC&PN	3" Polished Chrome & Nickel Finish
YKBL3-SB	3" Satin Brass Finish
YKBL3-SN&SC	3" Satin Nickel & Chrome Finish

### Box Contains

①	②	③	④	⑤
Pair of lever handles	1x Thumbturn & release	1x 85mm spindle suitable for 35mm & 45mm thick door	1x Allen key	8x Brass wood screws 1x Iron screw

  
**M Marcus Ltd., Dudley**

Product Code

R765

Material

Solid Brass

Available in all Heritage Brass finishes.

Sizes shown are in mm and approximate.  
We reserve the right to amend where  
necessary and without any prior notice.