

LEVER ON SQUARE ROSE

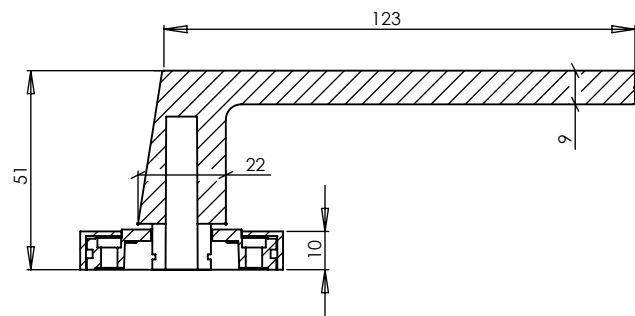

1

LEVER VIEW

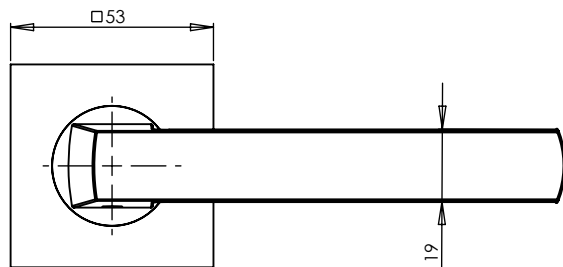

This latch handle is suitable for use with most U.K. tubular latches.

2

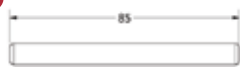

Spindle : 7.8mm x 85mm



3

2x Machine screws Male & Female
for 35mm to 44mm door
For a secure bolt through fixing

4

Steel wood screws
To eliminate rose rotation

FINISHES



Satin Chrome Finish



Polished Chrome Finish



Matt Black finish

Box
Contains

1

Lever
handles

2

1x spindle suitable for 35mm to
44mm thick door
1 x Allen Key

3

2x Machine screws

4

8x Steel
wood screws

M Marcus Ltd., Dudley

Product Code

Description

Material

Sizes shown are in mm and approximate.
We reserve the right to amend where
necessary and without any prior notice.

SC-4062

Axis Door Handle on Square Rose

Zinc Alloy